

ITEM #	DESCRIPTION	QTY.
1	BACK PLATE	1
2	LEFT SIDE PANEL	1
3	RIGHT SIDE PANEL	1
4	FRONT PANEL	1
5	COVER	1
6	VENT TRAY	1
7	RECTANGULAR PLATE	6

4U FOR EQUIPMENT MOUNTED  
VERTICALLY ON BACKPLATE

2U FOR EQUIPMENT MOUNTED  
VERTICALLY INSIDE OF BACKPLATE

8U FOR EQUIPMENT MOUNTED  
VERTICALLY ON SIDE PANELS

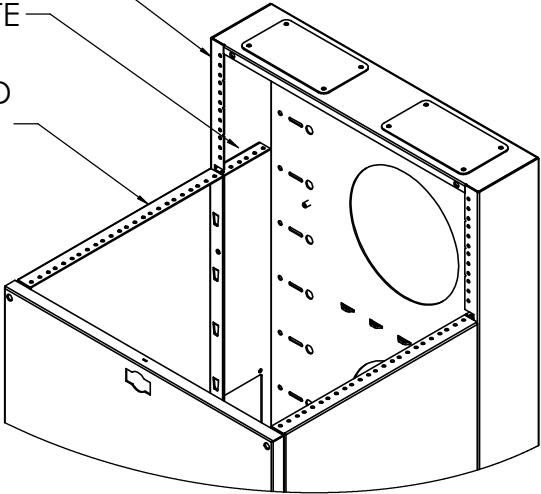
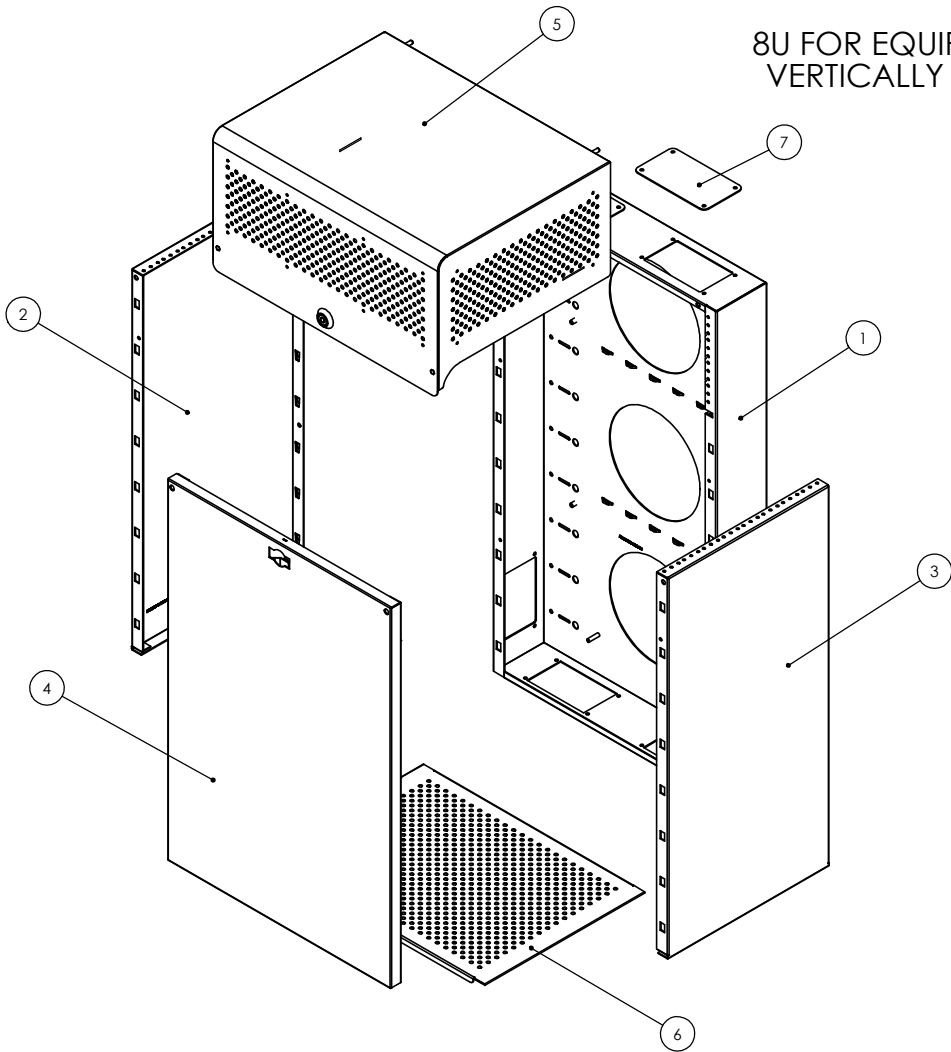

- NOTES:**
1. INSTALLATION MUST COMPLY WITH NATIONAL AND LOCAL ELECTRICAL REGULATIONS.
  2. ALL DIMENSIONS ARE IN INCHES.
  3. NET WEIGHT OF UNIT IS 69 LBS.
  4. CABLE ENTRY IS TOP, BOTTOM, AND SIDES OF UNIT.
  5. EQUIPMENT MOUNTING IS 12-24 TAPPED IN EIA PATTERN.
  6. CAPACITY IS 400 LBS. WHEN MOUNTED AS RECOMMENDED.
  7. CONSTRUCTION IS 14AWG C.R. STEEL WITH BLACK POWDER COAT FINISH.



**Black Hawk Labs**

PROPRIETARY AND CONFIDENTIAL

THE INFORMATION CONTAINED IN THIS DRAWING IS THE SOLE PROPERTY OF BLACKHAWKLABS. ANY REPRODUCTION IN PART OR AS A WHOLE WITHOUT THE WRITTEN PERMISSION OF BLACKHAWKLABS IS PROHIBITED.

COMMENTS:			
MRQ300S14 Sheet 1/2			
TITLE:			
MiniRaQ Standard			
SIZE	DWG. NO.	DATE	REV
C	90-067	3-20-11	2
SCALE: 2:1		WEIGHT: 69 lbs	SHEET 1 OF 2

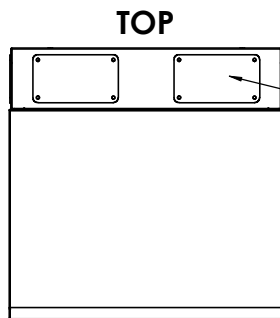

TOP

TWO PLATES COVERING  
3"x5" CABLE ACCESS OR  
ACCESSORY HOLES

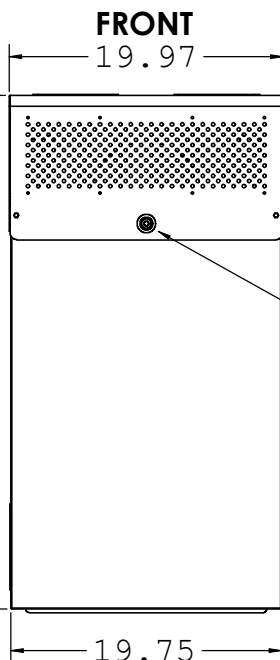

FRONT

DOUBLE  
CAM LOCK

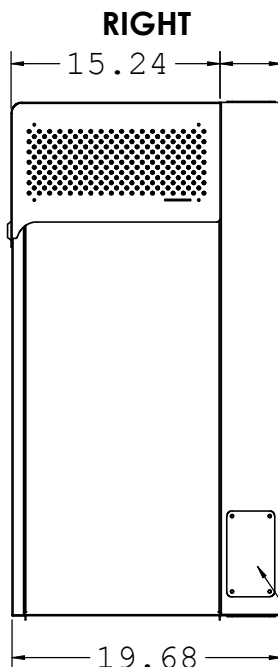

RIGHT

10 RAISED BRIDGE  
LANCES FOR CABLE  
MANAGEMENT (INTERNAL)

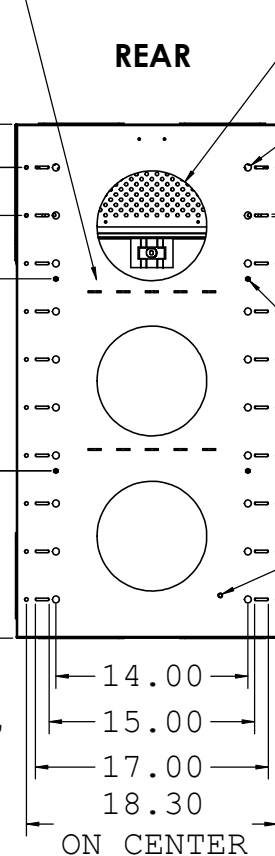

REAR

Ø 8.00

Ø .50

Ø .27

.19

FOUR PEM  
INSERTS  
FOR PLYWOOD  
OPTION  
(INTERNAL)

GROUND STUD  
(INTERNAL)

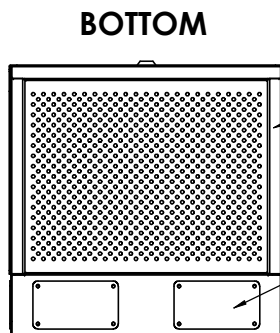

BOTTOM

LOWER VENT TRAY

TWO PLATES COVERING  
3"x5" CABLE ACCESS OR  
ACCESSORY HOLES

ONE PLATE EACH  
SIDE COVERING 3"x5"  
CABLE ACCESS OR  
ACCESSORY HOLES

**NOTES:**

1. INSTALLATION MUST COMPLY WITH NATIONAL AND LOCAL ELECTRICAL REGULATIONS.
2. ALL DIMENSIONS ARE IN INCHES.



PROPRIETARY AND CONFIDENTIAL  
THE INFORMATION CONTAINED IN THIS  
DRAWING IS THE SOLE PROPERTY OF  
BLACKHAWKLABS. ANY REPRODUCTION  
IN PART OR AS A WHOLE WITHOUT  
THE WRITTEN PERMISSION OF  
BLACKHAWKLABS IS PROHIBITED.

COMMENTS:				
MRQ300S14 Sheet 2/2				
TITLE: MiniRaQ Standard				
SIZE <b>C</b>	DWG. NO. 90-067	DATE 3-20-11	REV 2	
SCALE: 2:1		WEIGHT: 69 lbs		SHEET 2 OF 2